

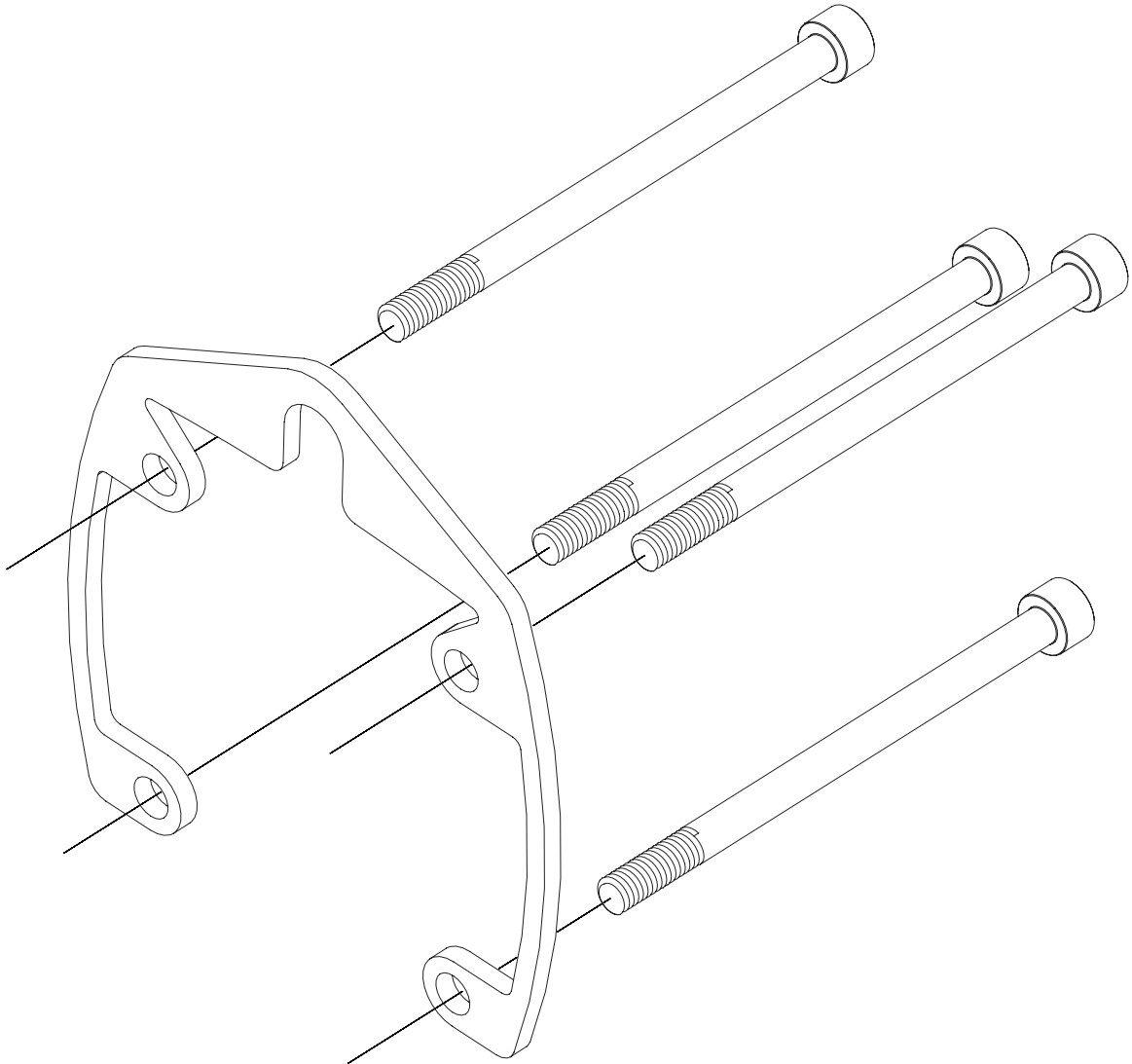

Snap-on Power Tools, Inc.

**TETHER INSTALLATION FOR IW750MP SERIES  
PISTOL GRIP IMPACT WRENCH  
SERIAL "A"**



**IW750 Tether Installation**

- Clamp the tool to prevent the separation of the nose from the housing.
- Remove the factory installed housing screws using a 5mm hex drive. Discard the old housing screws.
- Install the tether plate using the provided screws.
- Torque the new housing bolts in a cross pattern to 30 in-lbs

This pdf incorporates the following model numbers:

IW750MP, 74994A