



PARTS LIST FOR NO. 1654B 3/4" AIR REGULATOR

WARNING

EXCEPT as otherwise specified by the manufacturer, this product is specifically designed for compressed air service, and use with any other fluid (liquid or gas) is a misapplication. For example, use with or injection of certain hazardous liquids or gases in the system (such as alcohol or liquid petroleum gas) could be harmful to the unit or result in a combustible condition or hazardous external leakage. Manufacturer's warranties are void in the event of misapplication, and manufacturer assumes no responsibility for any resulting loss. Before using with fluids other than air, or for nonindustrial applications, consult manufacturer for written approval.

INSTALLATION

1. Refer to above warning
2. Maximum inlet pressure is 300 psig (20,7 bar); maximum inlet temperature is 175° F (79,4° C).
3. Install the unit ahead of and as close as possible to where regulated air is needed.
4. Install the unit with the air flowing through body in the direction indicated by the arrow.
5. Install the same pipe size unit as the pipe size in use. Avoid using fittings, couplings etc. that restrict the airflow, unless maximum flow is not needed.
6. Regulator may be installed so that adjusting handle is in any position. Attach gauge to one 1/4" gauge port and plug the other 1/4" gauge port.
7. Turning the adjusting screw clockwise raises the regulated pressure, and turning it counterclockwise lowers the regulated pressure.

MAINTENANCE

1. Occasionally remove bottom plug and clean plug, body and valve.
2. **TO DISASSEMBLE:** Shut off air supply and vent air lines on both sides of regulator. Turn adjusting screw counterclockwise to relieve compression or spring. Remove cover, retaining ring, bonnet, spring disc, and piston. By removing bottom plug and spring, the valve can be removed from the bottom of the regulator.
3. **TO ASSEMBLE:** Relubricate all seals and sealing surfaces with Dow Corning 44 silicone Grease. Replace valve, bottom spring, and bottom plug. Insert piston into body, place spring, spring disc, and bonnet in position, and install retaining ring and cover. **RETAINING RING MUST BE FULLY SEATED IN GROOVE.**
4. **IF UNIT WILL NOT REGULATE TO PRESSURE NEEDED, OR IF PRESSURE DROP BECOMES EXCESSIVE:** Remove bottom plug, spring and valve. Clean and check o-rings, valve and valve seat for wear or damage. Relubricate o-rings with Dow Corning 44 Silicone grease. Replace worn or damaged parts.

REPAIR KITS AND REPLACEMENT PARTS

Part No	Description
00121	Standard—Pressure Gauge (0-160 psi)
66195	Repair Kit—Self-Relieving
66196	Piston Kit—Non-Relieving

Furnish Catalog And Serial Number When Ordering Parts

SIoux TOOLS INC.

250 SNAP-ON DRIVE ■ PO BOX 1596 ■ MURPHY, NC 28906 ■ USA ■

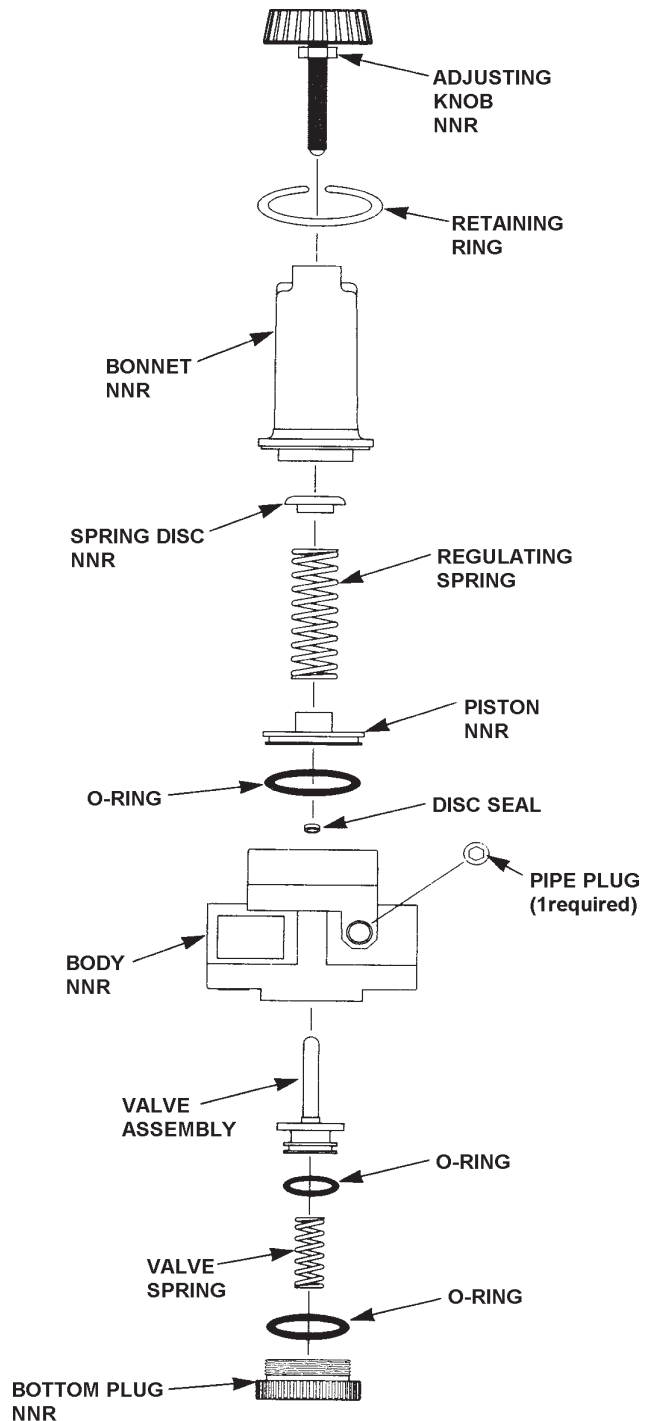

NNR=NOT NORMALLY REPLACED

This pdf incorporates the following model numbers:

1651MA, 1654B