



NOTE: Parts are no longer available for this tool.

The manual will continue on the next page.



PARTS LIST FOR 8110JV 1/2" REVERSING VARIABLE SPEED DRILL

Form No. Z270
Date 2-94

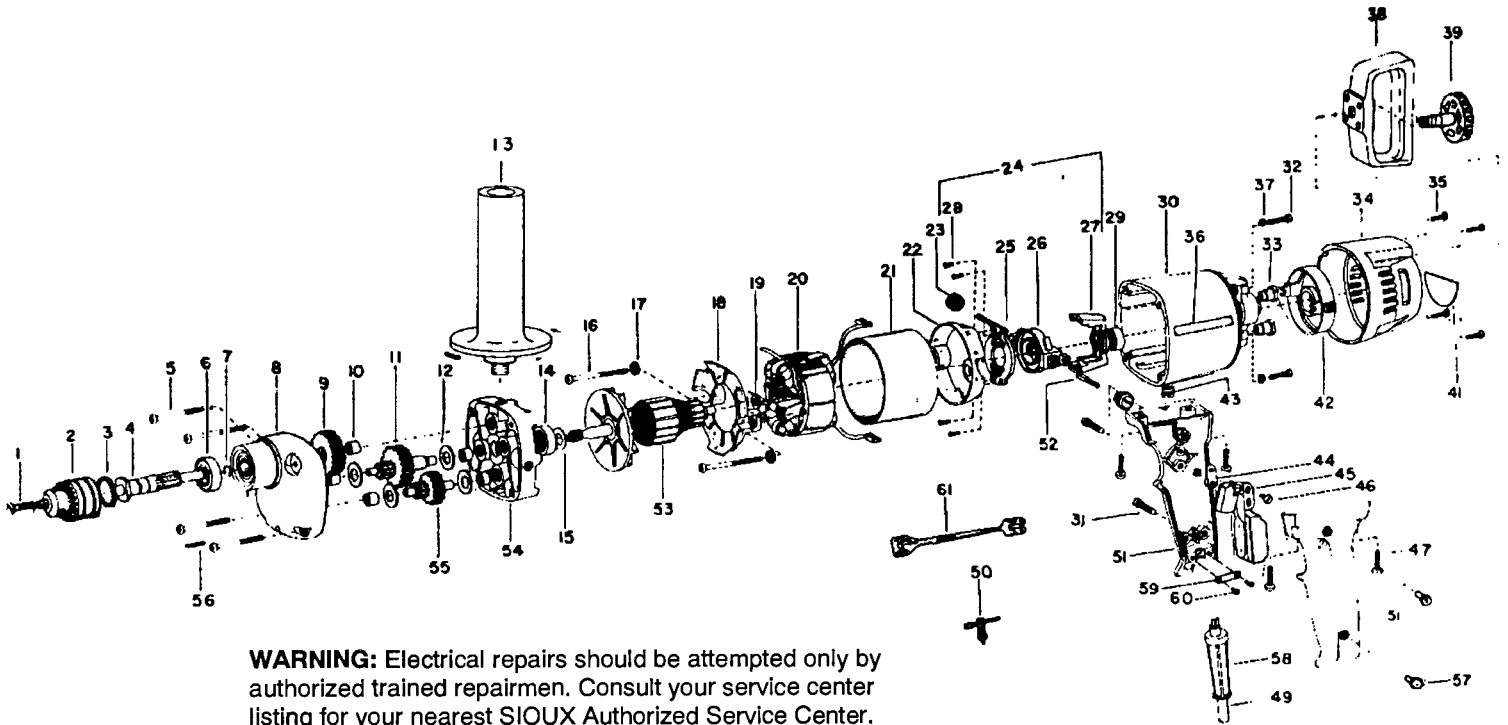

WARNING: Electrical repairs should be attempted only by authorized trained repairmen. Consult your service center listing for your nearest SIOUX Authorized Service Center.

Fig. No.	Part No.	Description
1.	08177	Screw
2.	21136	Chuck
3.	21815	Ring—Retaining
4.	22689	Spindle
5.	07246	Screw (4)*
6.	10123	Bearing
7.	21816	Ring—Retaining
8.	12665	Case—Gear
9.	19254	Gear—Spindle
10.	10089	Bearing—Needle (5)*
11.	19351	Gear—2nd Intermediate
12.	35738	Washer—Fiber (4)*
13.	63348	Handle—Side
14.	10210	Bearing—Ball
15.	35730	Spacer
16.	07243	Screw (2)*
17.	09724	Washer—Lock (2)*
18.	04019	Ass'y—Baffle
	54929	Bushing (2)*
20.	28964J	Field
21.	05056	Sleeve—Insulating
22.	04002	Insulator—Frame
23.	18109	Cap—Brush Holder (2)*
24.	28165	Ass'y—Brush Holder Ring
25.	28169	Ass'y—Support Cover
26.	28172	Ring—Brush Holder
27.	28170	Support
28.	06125	Screw (4)*
29.	10931	Bearing—Ball

Fig. No.	Part No.	Description
30.	12664	Frame
31.	06596	Screw (2)*
32.	06595	Screw (2)*
33.	04009	Bushing—Insulating (2)*
34.	04013	Cap—Back
35.	07244	Screw (4)*
36.	20809	Strip—Decal (2)*
37.	09836	Washer—Lock (2)
38.	04012	Handle—Spade
39.	04010	Knob
41.	20017R	Nameplate
42.	28171	Ring—Reversing
43.	04016	Bushing—Lead Insulating
44.	04008	Spacer—Switch
45.	18230	Switch
46.	06660	Screw
47.	07245	Screw (4)*
49.	18467	Cord
50.	30011	Key—Chuck
51.	04022JV	Ass'y—Handle
	13321	Inserts (2)*
52.	18023	Brush—Motor (Pair)
53.	28966J	Armature
54.	63345	Separator
55.	19350	Gear—1st intermediate
56.	40145	Pin—Roll
57.	54930	Nut (2)*
58.	04303	Guard—Cord
59.	35726	Clamp—Cord
60.	06241	Screw (2)
61.	04305	Holder—Key

Furnish Catalog Number When Ordering Parts

*Order Quantity Needed

**SIOUX
TOOLS INC.**

2901 FLOYD BOULEVARD ■ PO BOX 507 ■ SIOUX CITY, IOWA 51102-0507 ■

Printed in U.S.A.

This pdf incorporates the following model numbers:

8110JV