

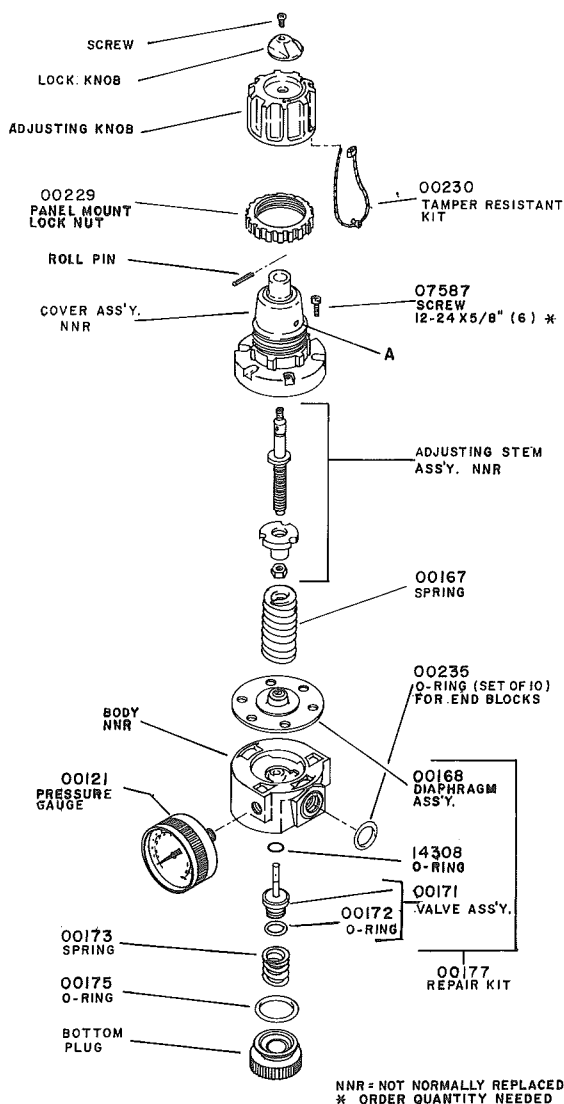

NOTE: Parts are no longer available for this tool.

The manual will continue on the next page.

Parts List and Service Manual for No. 1662 Modular Air Regulator Installation



INSTALLATION

1. Maximum inlet pressure and operating temperature ratings are 300 PSIG (21 bar) and 175° F (79° C).
2. Install as close as possible to where regulated air is needed.
3. Install the unit with the air flowing through the body in the direction indicated by the arrow.
4. Install the same pipe size unit as the pipe line in use. Avoid using fittings, couplings, etc., that restrict the airflow, unless maximum flow is not needed.
5. Regulator may be installed so that adjusting handle is in any position. Attach gauge to one 1/4" female gauge port and plug the other 1/4" female port, or use it as a regulated outlet port.
6. Turning the adjusting screw in raises the regulated pressure and turning it out lowers the regulated pressure.
7. Panel mount regulators require a 1-7/8" diameter hole and are mountable on panels from 1/8" to 9/16" thick.

MAINTENANCE

1. Occasionally remove bottom plug and clean plug, body, and valve seat (vent air line on both sides of regulator).
2. TO DISASSEMBLE shut off air to regulator and vent air line on both sides of regulator. Turn adjusting screw out to relieve compression on spring. Remove screws, cover, spring, and spring disk. Diaphragm assembly can now be removed. By removing bottom plug and spring, the valve can be removed from the bottom of the regulator.
3. IF UNIT WILL NOT REGULATE TO PRESSURE NEEDED OR IF PRESSURE BECOMES EXCESSIVE, remove bottom plug, spring, and valve assembly. Clean and check o-ring, valve stem and valve seat for water damage. Replace worn or damaged parts. Install Repair Kit No. 00177 for self-relieving models, for complete overhaul.
4. IF UNIT LEAKS AT RELIEF PORT A, install proper repair kit as listed.
5. WHEN REPLACING DIAPHRAGM ASSEMBLY—diaphragm assembly 00168 includes relieving disk seal (not shown).
6. TO REPLACE O-RING—this o-ring is above a metal washer which cannot be removed. Using a pointed probe of some kind, pull o-ring out. Force new ring through washer hole into o-ring cavity.

TO OVERHAUL SELF-RELIEVING MODELS, ORDER
REPAIR KIT NO. 00177

CAUTION

EXCEPT as otherwise specified by the manufacturer, this product is specifically designed for compressed air service, and use with any other fluid (liquid or gas) is a misapplication. For example, use with or injection of certain hazardous liquids or gases in the system (such as alcohol or liquid petroleum gas) could be harmful to the unit or result in a combustible condition or hazardous external leakage. Manufacturer's warranties are void in the event of misapplication, and manufacturer assumes no responsibility for any resulting loss.



SIoux
TOOLS INC.

2901 FLOYD BOULEVARD ■ SIOUX CITY, IOWA 51102 ■

This pdf incorporates the following model numbers:

1662