



**NOTE: Parts are no longer available for this tool.**

**The manual will continue on the next page.**



# SIoux TOOLS INC.

2901 FLOYD BOULEVARD ■ SIOUX CITY, IOWA 51102 ■

Form No. A634  
Dated 8/79

## Parts List for No's. 1267, 1269 – 7" Sanders 1268 – 7" Grinder

(1267 – Serial No's. Starting with "D")  
(1268, 1269 – Serial No's. 100 & Up)

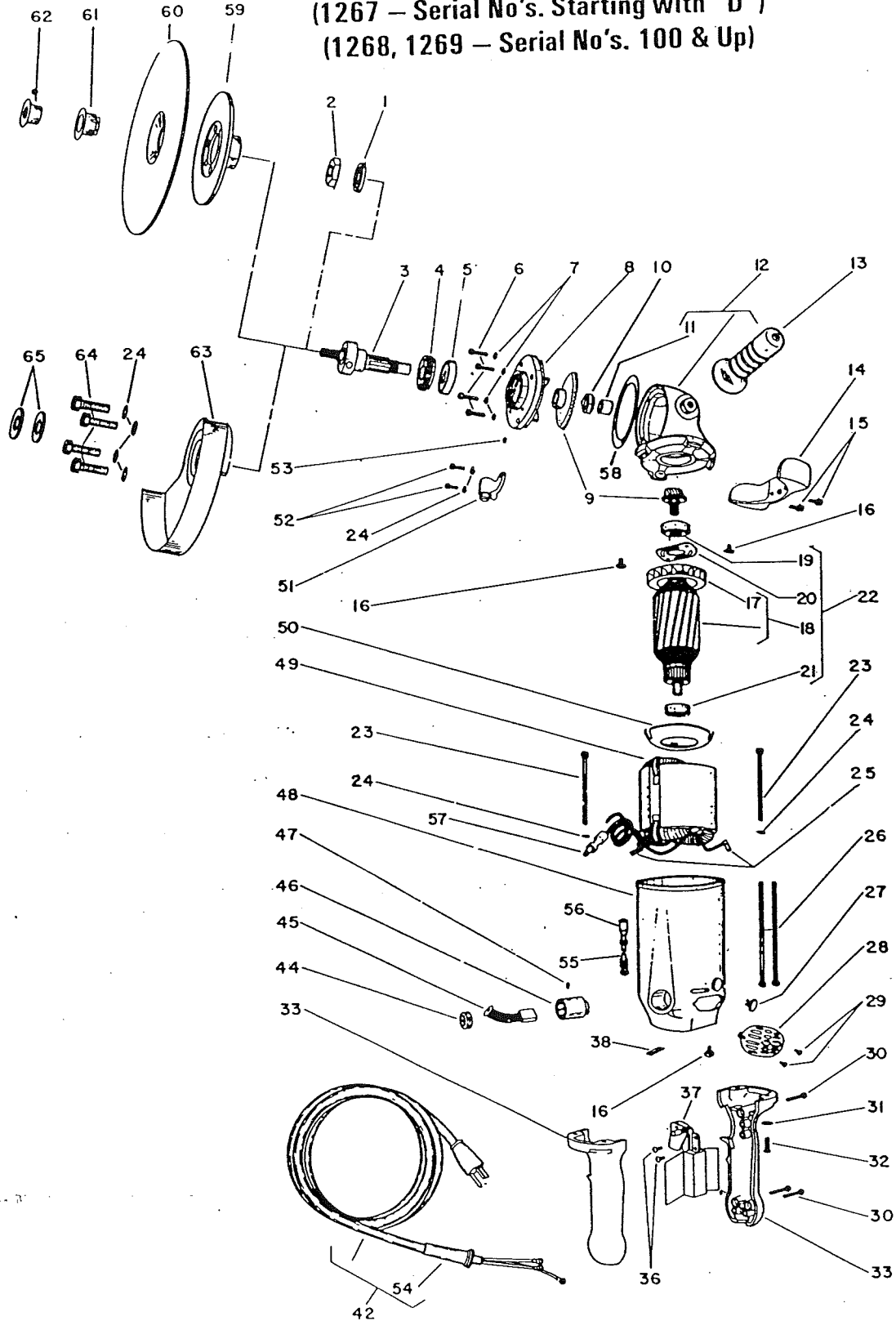

Furnish Catalog, Serial and Model Number When Ordering Parts

# Parts List for No's. 1267, 1269 — 7" Sanders 1268 — 7" Grinder

(1267 — Serial No's. Starting with "D")  
(1268, 1269 — Serial No's. 100 & Up)

Furnish Catalog, Serial and Model Number When Ordering Parts

Fig- ure	Part No.	Name
1	09657	Nut—Tool Spindle (1267, 1269)
2	24295	Flange—Outside (1267, 1269)
3	22903	Ass'm.—Tool Spindle
4	23017	Ass'm.—Oil Seal
5	10141	Bearing—Ball
6	07114	Screw—#10 (4)* (1267, 1269)
7	14613	Washer (4)*
8	12009	Support—Bearing
9	19701	Gear—Matched Set, Spiral Bevel Gear & Pinion (5000 R.P.M.) (1267)
	19700	Gear—Matched Set, Spiral Bevel Gear & Pinion (7000 Max. R.P.M.) (1268, 1269)
	24023	Slinger—Grease (5000 R.P.M.) (1267)
	24021	Slinger—Grease (7000 Max. R.P.M.) (1268, 1269)
10	09693	Nut—Elastic Stop
11	10023	Bearing—Needle
12	12008	Gear Case
13	23006	Ass'm.—Side Handle
14	35271	Air—Director
15	07210	Screw—#10 (2)*
16	07204	Screw—#10 (3)*
17	21565	Fan
18	28525	Ass'm.—Armature & Fan
19	10127	Bearing—Ball
20	25016	Plate—Bearing Lock
21	10112	Bearing—Ball
22	16833	Ass'm.—Armature, Fan & Bearings
23	07134	Screw—#10 (2)*
24	09724	Washer—Lock [(4)* 1267, 1269], [(8)* 1268]
25	18860	Clip—Terminal (2)*
26	07153	Screw—#10 (4)*
27	34976	Button—Wear
28	23091	Ass'm.—Open Insp. Hole Cover
29	06090	Screw—#4 (2)*
30	06655	Screw—#8 (3)*
31	35234	Washer (4)

Fig- ure	Part No.	Name
32	07223	Screw—#10 (4)*
33	53786	Ass'm.—Handle Complete
36	06673	Screw—#8 (2)*
37	18204	Switch
38	14697	Retainer—Wire
42	18416	Ass'm.—Cord & Terminals
	18417	Ass'm.—Cord & Terminals (30 foot)
	53535	Ass'y.—Handle, Switch & Cord
44	18120	Cap—Brush Holder (2)*
45	18018	Brush—Motor (2)*
46	18075	Holder—Brush (2)*
47	07000	Screw—#10 (2)*
48	12333	Housing
49	28590	Field—Motor
50	25014	Plate—Baffle
51	23189	Ass'm.—Tool Spindle Lock
52	07110	Screw—#10 (2)*
53	06404	Screw—#8
54	04219	Relief—Strain
55	28111	Ass'y.—Lead Wire (Incl's. Fig. 56) (2)*
56	28084	Plug—Bullet (Female) (2)*
57	28083	Plug—Bullet (Male) (2)*
58	14324	Gasket (1268)
59	544	Sanding Disc Holder (1267, 1269)
60	548	Disc Pad (1267, 1269)
61	542	Backing Disc Retainer (1267, 1269)
62	543	Lock Nut (1267, 1269)
63	2325	Ass'y.—Guard (Incl. Figs. 24, 58, 64, 65) (1268)
64	07094	Screw—Soc. Hd. Cap #10-24 X 1-3/4" (4)* (1268)
65	25894	Washer (2)* (1268)
	20451	Plate—Name (1267)
	20452	Plate—Name (1268)
	20453	Plate—Name (1269)
	09954	Drive—Screw (2)*



**SIoux  
TOOLS INC.**

2901 FLOYD BOULEVARD ■ SIOUX CITY, IOWA 51102 ■

PRINTED IN U.S.A.

This pdf incorporates the following model numbers:

1267, 1268, 1269