

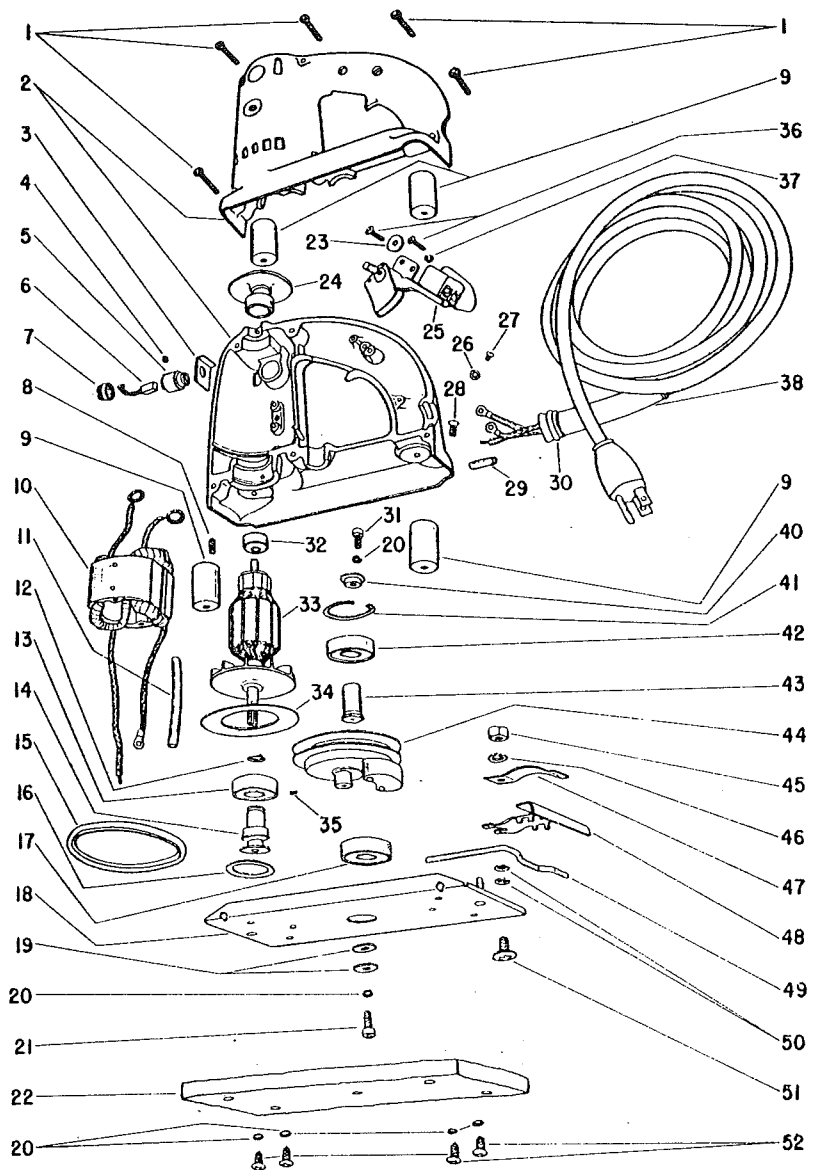

**NOTE: Parts are no longer available for this tool.**

**The manual will continue on the next page.**



**INSTRUCTIONS FOR INSTALLING (Fig. 15) NO. 14442 BELT.**

- 1— Remove 4 Screws, fig. 52 Lift off the cushion plate, fig. 22.
- 2— Remove 1 Screw, fig. 21 Note; to hold fig. 44 pulley from turning, insert a small screw driver blade through the hole in side of fig. 18 Sol plate.
- 3— Gently pry off the sole plate which may stick a little.
- 4— Remove 1 screw, fig. 31.
- 5— Remove Pulley, fig. 44. Install Belt and assemble in reverse order.

**SIoux TOOLS INC.**

Sioux City, Iowa, U.S.A. 51102

This pdf incorporates the following model numbers:

14442