



ASSEMBLY



ID375AP-2Q



IW375AP-3P

IMPROVED PRODUCTIVITY

With this new impact you will now be able to drive fasteners more quickly and efficiently than ever before, with no torque reaction. The impact rate has been increased to 5,000 blows per minute.

Improved Durability

Steel Ball (ME9A14)

A steel ball was added between the face on the top of the carrier and the face on the bottom of the anvil. This raises the two surfaces away from each other and the initial wear happens between the steel ball and the drill point in the inside of the anvil.

Needle Bearing (ME11B26)

The needle bearing is pressed beyond flush with the bottom of the anvil. By pressing the bearing deeper into the anvil it eliminates the possibility of the carrier wearing into the bearing.

Gear Carrier (74837) Gear Idler Pin (30062)

The gear carrier was updated to have a thicker flange area and a longer gear idler pin was added. The thicker carrier and longer pins allows for a better press fit between the two parts, keeping the pin firmly in the carrier during operation.

Bronze Bushing (74848)

The needle bearing was changed to a bronze bushing for increased life and durability.

Ring Guide (74847)

The ring guide was updated to a stronger and more durable material.

Spring (74840)

The spring was updated from the previous music wire version to a new stronger, longer lasting material in order to eliminate failure due to spring fatigue and fracture.

Gear Case/Ring Gear (74838)

The gear case/ring gear was made slightly longer to accommodate the increased thickness of the gear carrier flange

There were no performance issues with the ring gear however due to the thicker flange the current gear case will not work with the new carrier.

The new carrier **MUST** be used with the new gear case in order for the tool to function correctly.

O-Ring (74841)

A new O-Ring was added contain grease within the mechanism area and eliminate any leaking towards the housing.

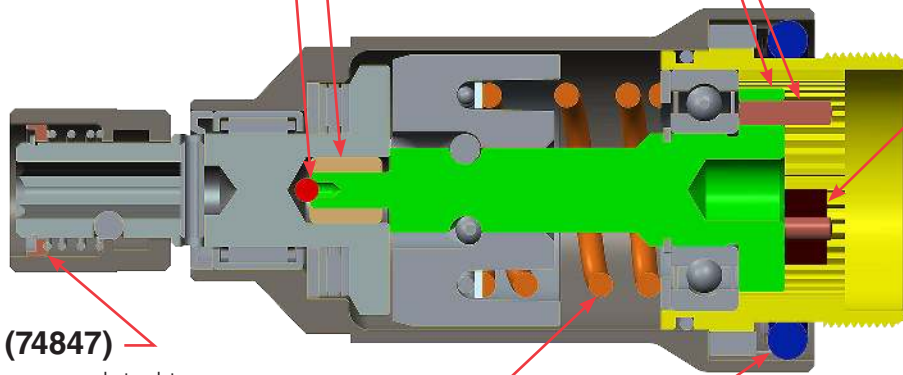

Notes:

Attention: All new updated and built versions of these tools are marked with "Serial B" on the nose piece.

If you would like to update a previous "Serial A" tool to the new "Serial B" version you can do so by ordering the individual parts above or to help make it an easy change over we have set up complete nose assemblies so that all you will have to do is unscrew the current impact nose assembly and screw in and torque down the new one.

Complete Assembly Part Numbers:

- 74842** Quick Change Impact Nose Assembly for Service
- 74843** Pinned Anvil Impact Nose Assembly for Service
- 74844** Friction Ring Impact Nose Assembly for Service



IMPROVED ERGONOMICS

This NEW Impact Driver is built off of the Sioux Signature Series platform, which has already incorporated comfort and ergonomics into its handle design. Ideally a person should be able to operate a tool only using one hand. According to OSHA awkward working positions and body postures such as bending of the wrist are major contributors that can affect the health and performance of hand tool users. When the hand holds and uses a tool in an awkward position it has less strength and as a result is more susceptible to soreness and eventual injury. OSHA states that crucial ergonomic principle to remember is **“bend the tool, not the wrists.”** When using the new design the user has a better posture and can apply more axial force into the application.

Ease of Serviceability

This new impact has been designed for ease of maintenance based on the Signature Series platform

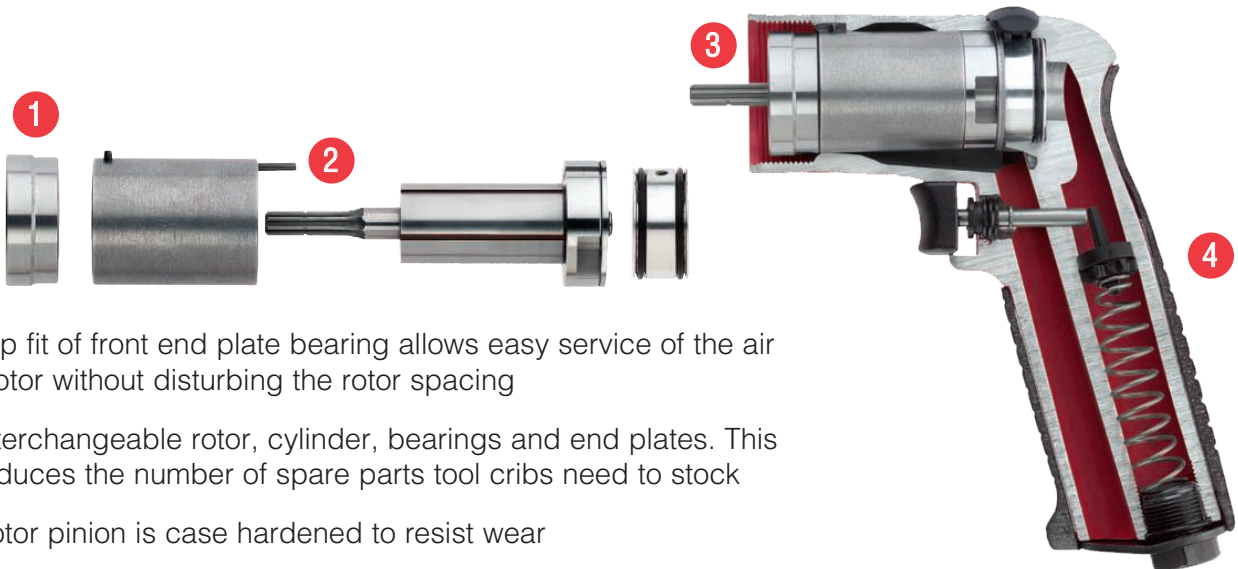

- 1 Slip fit of front end plate bearing allows easy service of the air motor without disturbing the rotor spacing
- 2 Interchangeable rotor, cylinder, bearings and end plates. This reduces the number of spare parts tool cribs need to stock
- 3 Rotor pinion is case hardened to resist wear
- 4 Tipper valve and valve seat is easily accessible for service

1/4" (6 MM) IMPACT DRIVER



ID375AP-2Q



3/8" (10 MM) IMPACT WRENCH



IW375AP-3P

Key Features:

- High power to weight ratio
- High impact rate of 5,000 blows per minute
- Working torque range up to 95 ft/lbs
- Extended life through bearing design
- Smooth Impacting that creates minimal torque reaction
- Includes rubber boot for hammer case

Applications:

- Wood Screws
- Self-tapping screws
- Lag bolts
- High prevailing torque applications

Impacts



Model Number	Drive Size		Working Torque Range ¹		Maximum Torque		Blows Per Minute	Free Speed rpm	Weight		Length		Side To Center		Socket Retainer Style
	in	mm	ft lb	Nm	ft lb	Nm			lb	kg	in	mm	in	mm	
Pistol Grip Impact Driver															
ID375AP-2Q	1/4	6	10-55	13-75	60	80	5000	4000	2.5	1.1	8.5	216	085	21	Quick Change
Pistol Grip Impact Wrench															
IW375AP-3P	3/8	10	10-95	13-130	100	135	5000	4000	2.5	1.1	8.5	216	085	21	Pin
IW375AP-3F	3/8	10	10-95	13-130	100	135	5000	4000	2.5	1.1	8.5	216	085	21	Ring

¹ Maximum working torque determined by 5 second rundown on appropriate Skidmore-Wilhelm Torque-Tension Tester.

General:

Air Inlet Size: 1/4" NPT • Recommended Hose Size: 3/8" (10 mm) • Performance rated @ 90 psig (6.2 bar) air pressure

siouxtools.com



250 Snap-on Drive
P.O. Box 1596
Murphy, North Carolina USA 28906
PH: 828.835.9765
FAX: 828.835.9685
TOLL FREE: 866.259.7291
TOLL FREE FAX: 800.722.7236

Benelux
Tel: (N) +31-(0)880-104000
(B) +32 (0)14-231967
Fax: (N) +31-(0)880-104010
(B) +32 (0)14-232627
e-mail: (N) industrial.nl@snapon.com
(B) industrial.be@snapon.com

Latin America
Tel.: 305-271-0944
Fax: 305-271-7152
e-mail: latinamerica.caribbean@snapon.com

Germany
Tel.: 49 2104 9509-0
Fax: 49 2104 9509-99
e-mail: indus.germany@snapon.com

Italy
Tel.: 00 39 02 66 04 53 70
Fax: 00 39 02 61 29 78 15
e-mail: indus.italia@snapon.com

United Kingdom
Tel.: 44 (0) 1536-413904
Fax: 44 (0) 1536-413874
e-mail: industrialuk@snapon.com

Asia
Tel.: 65-6451-5570
Fax: 65-6451-5574
e-mail: esales.sg@snapon.com

Australia
Tel.: 61 2 9837 9100
Fax: 61 2 9624 2578
e-mail:
SOTA.customerservice@snapon.com

