



PARTS LIST FOR NO. 1663 MODULAR AIR FILTER

Form No. A733A
Date 3/93

WARNING

DO NOT PLACE PLASTIC BOWL UNIT IN SERVICE WITHOUT METAL BOWL GUARD INSTALLED

Plastic bowl units are sold only with metal bowl guards. To minimize the danger of flying fragments in the event of plastic bowl failure, the metal bowl guards should not be removed. If the unit is in service without metal bowl guard installed, manufacturer's warranties are void, and the manufacturer assumes no responsibility for any resulting loss.

IF UNIT HAS BEEN IN SERVICE AND DOES NOT HAVE A METAL BOWL GUARD, ORDER ONE AND INSTALL ONE BEFORE PLACING UNIT BACK IN SERVICE.

For information on materials harmful to plastic bowls, contact a Mobay Chemical or General Electric Office for more information regarding materials that will attack polycarbonate plastic.

CAUTION

Certain compressor oils, chemicals, household cleaners, solvents, paints, and fumes will attack plastic bowls and can cause bowl failure. Do not use near these materials. When bowl becomes dirty replace bowl or wipe only with clean, dry cloth. Reinstall metal bowl guard or buy and install a metal bowl guard. Immediately replace any crazed, cracked, damaged, or deteriorated plastic bowl with a new plastic bowl and metal bowl guard

EXCEPT as otherwise specified by the manufacture, this unit is specifically designed for compressed air service and use with any other fluid (liquid or gas) is a misapplication. For example, use with or injection of certain hazardous liquids or gases in the system (such as alcohol or liquid petroleum gas) could be harmful to the unit or result in a combustible condition or hazardous external leakage. Manufacturer's warranties are void in the event of misapplication, and manufacturer assumes no responsibility for any resulting loss. Before using with fluids other than oil or for non-industrial applications or for life-support systems consult manufacturer for written approval.

INSTALLATION

1. Refer to the above warning.
2. Install as close as possible to point where air is being used.
3. Install the unit with the air flowing through the body in the direction indicated by arrow.
4. Install the same pipe-size unit as the pipeline in use. Avoid using fittings, couplings, etc., that restrict air flow.
5. Do not install this unit on any application where the pressure drop will exceed 20 psi.
6. A drain line with 1/8" NPT connection may be attached to the drain port if desired. Drain line should be 1/4" tubing or larger, as short as possible, and crimp-free.
7. Maximum inlet pressure and operating temperature ratings are: transparent plastic bowls, 150 psig, (10 bar) and 125°F (52°C).
8. Install unit in a vertical position.

MAINTENANCE

1. TO CLEAN BOWL OR REPLACE FILTER ELEMENT:
 - a. Depressurize unit.
 - b. Inspect and replace crazed, cracked, damaged, or deteriorated seals and bowls with original manufacturer's approved seals and bowls.
 - c. IF BOWL BECOMES DIRTY, replace it or clean it by wiping it with a soft dry cloth.
2. IF UNIT HAS RIGID (FELT) FILTER ELEMENT, replace or clean it periodically. Remove element and tap it on a hard surface. Use an air gun to blow out residual dirt.
3. IF BOWL HAS AN AUTOMATIC MECHANICAL DRAIN, clean screen around drain seat whenever elements are cleaned or changed. Remove adapter nut. Remove drain assembly. Use an air gun to blow dirt out of screen and valve assembly.
4. BEFORE PLACING UNIT IN SERVICE, reinstall bowl and bowl guard and lock them securely in place.

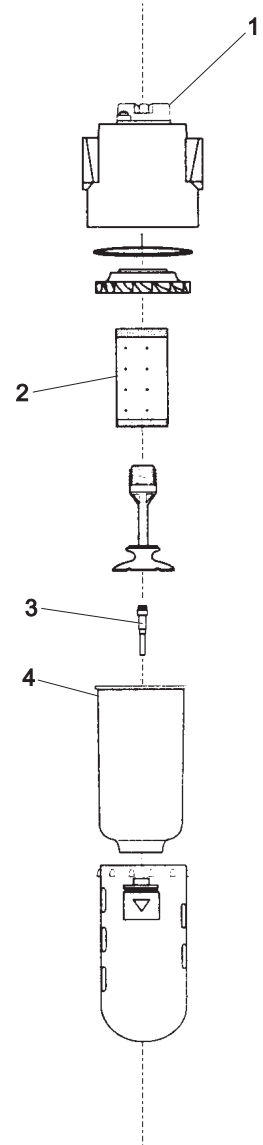

Fig. No.	Part No.	Name
1.	00235	"O" Ring Set for End Blocks (10)
2.	00227	Element Filter (Includes Bowl "O" Ring)
3.	00234	Drain—Flex
4.	00228	Plastic Bowl—W/Flex Drain and Metal Bowl Guard

SIoux TOOLS INC.

Furnish Catalog And Serial Number When Ordering Parts

250 SNAP-ON DRIVE ■ PO BOX 1596 ■ MURPHY, NC 28906 ■ USA ■

This pdf incorporates the following model numbers:

1660B